

# i4M Tracer GPS

## PRODUCT DETAILS

The i4M Tracer GPS is a cost effective GPS solution that provides accurate positioning for Variable Rate applications using i4M branded machine controllers.

The i4M Tracer GPS offers Auto Shut-off and Coverage mapping capabilities to increase productivity and minimise wastage of inputs.

The purpose build Tracer GPS receiver is mounted to the implement, sending GPS location and speed data over Wi-Fi to an Android tablet in the tractor cabin.

The Auto Shut-off function turns the implement off when the machine moves into an area of the paddock that has already been covered, minimising application of inputs on headlands and at the paddock boundaries.

Coverage mapping enables the user to log where the machine has been in the paddock. Coverage maps are stored for future reference.

Prescription maps are downloaded from the i4M cloud server and the system will also function without loading a prescription map in manual pre-set rate mode.

## GPS RECEIVER SPECIFICATIONS

- 32 Satellite Channels
- 10Hz Refresh rate
- Supports GPS, GLONASS, Gailleo and QZSS
- Sub 1m Positional Accuracy
- 12V Power



Device Requirements

### Android

- 10" Screen
- Android version 8 and above
- Minimum Storage : 32 GB
- 3/4G Sim Card
- Recommended Brand : Samsung

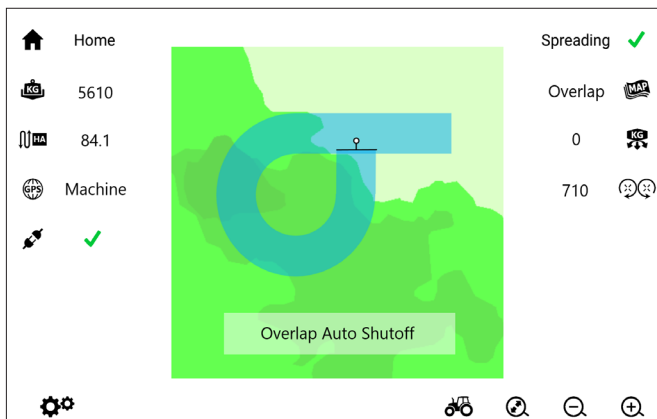

Auto Shut-Off Function

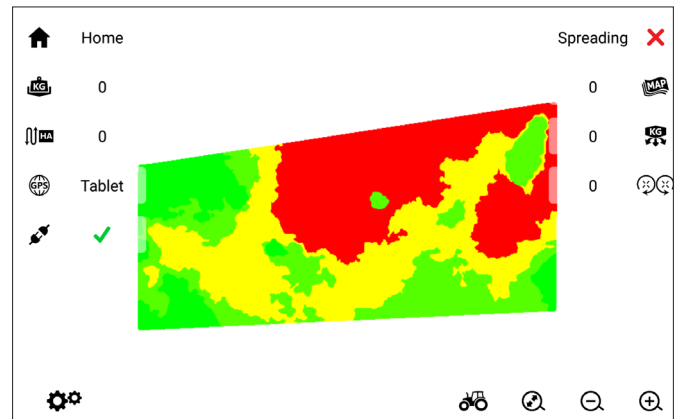

Prescription Map

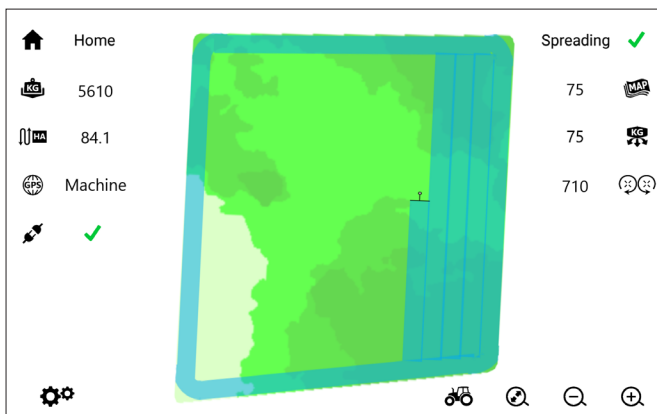

Coverage Mapping

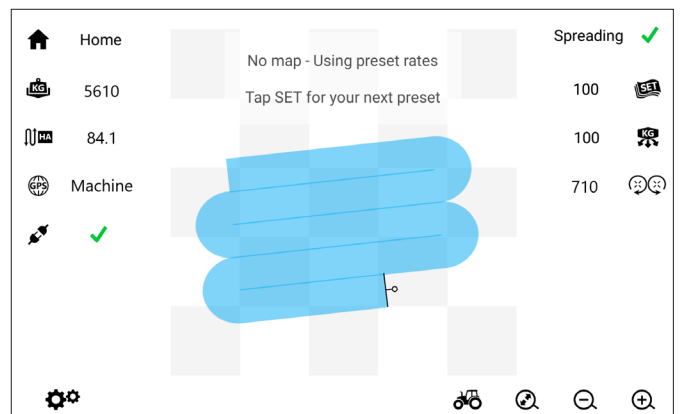

Preset Rate Mode



web : [i4m.net.au](http://i4m.net.au)

Connecting Agronomy with Machines

i4M developed by : Precision Agronomics Australia  
Lot 101 Turnbull St Harvey Western Australia 6220